

The 1st
International
Electric
Vehicle

Exhibition Announcement

The 1st International Electric Vehicle Expo

Mar. 15~21, 2014
JEJU, ICC JEJU

Contents

Introduction

Program

Schedule

Applications Guidelines

Floor Plan

Contact List

[Introduction]

- **Title:** The 1st International Electric Vehicle Expo
- **Date:** March. 15(Sat) ~ 21(Fri), 2014
- **Venue:** ICC Jeju, ICC, Event Hall(1F)
- **Host:** Ministry of Trade, Industry & Energy, Ministry of Environment, National Assembly Renewable Energy Policy Research Forum, Jeju Special Self-Governing Province
- **Organizer:** Jeju Smart Grid Corporation Association, Jeju National University Electric Vehicle Business Group, Jeju Development Institute, Korea Smart Grid Institute, Korea Automobile Manufacturers Association, Korea Automobile Importers and Distributors Association, The Korea Society of Automotive Engineers, The Korea Transport Institute, Electric Vehicle Leaders Forum
- **Support:** Korea Tourism Organization, Korea Trade-Investment Promotion Agency, Jeju Energy Corporation, Jeju Special Self-governing Province Development Corporation, Jeju Tourism Organization, Jeju Special Self-Governing Provincial Tourism Association, KIA MOTORS CORPORATION, Nissan Motor Co.,Ltd, Renault Samsung Motors Co., Ltd, Mitsubishi Motors Corporation, BMW KOREA, GM Korea Company, Hyundai Motor Company
- **Projected Size of Exhibition:** 2,395 m² / Number of Booth: 180ea (1 Booth= 9m²)
- **Exhibit Item:**
Electric vehicle, battery / charger, including power • energy devices and infrastructure, such as electric vehicle related products
- **Who should exhibit**
The 1st International Electric Vehicle Expo expected to have a large number of participants from various fields to include, academic societies, meetings and exhibition participants, universities, local governments, and electric vehicle industry managers, and other related organizations.

[Program]

	3/15(Sat.)	3/16(Sun.)	3/17(Mon.)	3/18(Tue.)-19(Wed.)	3/20(Tue.)-21(Fri.)				
0830	Registration (Conference & Exhibition)								
0900									
0930	Exhibition Opening								
1000									
1030	Exhibition & Event	Manufacturer Press Conference	Exhibition & Event	Electric vehicle Leaders Forum	Exhibition & Event	Branch Session	Exhibition & Event	Exhibition & Event	
1100				Break					
1130	Exhibition & Event	Manufacturer Press Conference	Exhibition & Event	Electric vehicle Leaders Forum	Exhibition & Event	Branch Session	Exhibition & Event	Exhibition & Event	
1200				Break					
1230	Lunch								
1300	Lunch								
1330	Lunch								
1400	Lunch								
1430	Conference Opening	Exhibition & Event	Manufacturer Press Conference	Exhibition & Event	Electric vehicle Leaders Forum	Exhibition & Event	Branch Session	Exhibition & Event	Exhibition & Event
1500	Keynote Session 1								
1530	Break	Exhibition & Event	Manufacturer Press Conference	Exhibition & Event	Electric vehicle Leaders Forum	Exhibition & Event	Branch Session	Exhibition & Event	Exhibition & Event
1600	Break								
1630	Keynote Session 1	Exhibition & Event	Manufacturer Press Conference	Exhibition & Event	Electric vehicle Leaders Forum	Exhibition & Event	Branch Session	Exhibition & Event	Exhibition & Event
1700	Break								
1730	Break	Exhibition & Event	Manufacturer Press Conference	Exhibition & Event	Electric vehicle Leaders Forum	Exhibition & Event	Branch Session	Exhibition & Event	Exhibition & Event
1800	Break								
1830	Welcoming Dinner (Hosted by President of IEVE Organizing Committee)	Welcoming Dinner (Hosted by President of Jeju Special Self-Governing Province)							
1900									

[Schedule]

Classification	Times & Date	Details
Move-in	08 : 00 ~ 18 : 00 Mar. 12~14, 2014	Exhibitor Registration Bring in exhibition items and Display
Opening Ceremony	10:00 ~ 10:30 Mar. 15, 2014	Exhibition Opening Tape Cutting
Exhibition	10:00 ~ 18:00 Mar. 15~21, 2014	Exhibition
Move-out	08:00 ~ 18:00 Mar. 22, 2014	Clearing of exhibition items and dismantling of displays

[Applications Guidelines]

- Booth Rental Fee

No	Category	Detail	Price (9sqm)
			KRW
1	Standard Booth	3mx3m	₩5,000,000
2	Space Only Booth	3mx3m	₩4,000,000

- Application Deadline: January 31, 2014

- Standard Booth



Height	2.5m
Back and Side Wall	3m x 3m
Aisle	Gray needle punch carpet
Lighting	3 spotlights (100W)
Fascia	Company name(Kor/Eng) and Logo
Outlet	1ea. (220V)
Furnishing	1 Information desk, 1 chair

※Fascia Board (Company Nameplate)

The 1st International Electric Vehicle Expo Organizing Committee will post a standard company nameplate (Approx. Size: 2,930mm*218mm) at the top of partitions. The exhibitors using Standard

Booth are requested to submit the accurate company name in Application Form so that the name can be attached to the stand booth.

- **“Space Only” Exhibitors**

Exhibitors who wish to build their own booths in unique designs should apply for the “space only” booth to the secretariat. The maximum height of the space only booths should be 5 meters.

Two (2) copies of the design plan of scale no less than 1:50, showing cross sections and elevations of the proposed booth and other structures which may not exceed 4 meters in height, must be submitted upon registration.

These copies should contain:

1. Design of the stand/booth in perspective views
2. Mechanical and electrical drawings
3. Specification of the materials used in the drawings

The final proposed plan should be submitted by Feb.10. 2014.

- **Additional Services**

For all additional requirements, the 1st International Electric Vehicle Expo Organizing Committee will notify later.

- **Miscellaneous**

- Exhibitor badges
(* All personnel in the exhibition hall must wear identification badges at all times.)
- Coffee Break
- Shuttle bus service (ICC JEJU – Official Hotels)

[Floor Plan]

-1F

The 1st International Electric Vehicle Expo_Exhibition Hall Floor Plan (1F)

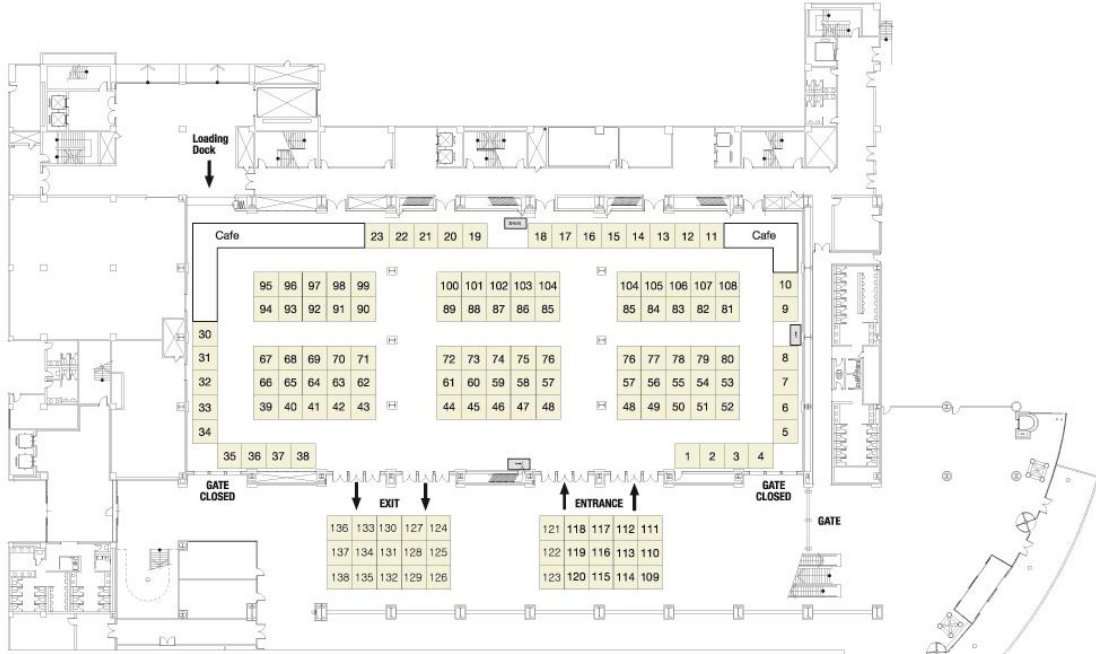

-3F

The 1st International Electric Vehicle Expo_Exhibition Hall Floor Plan (3F)

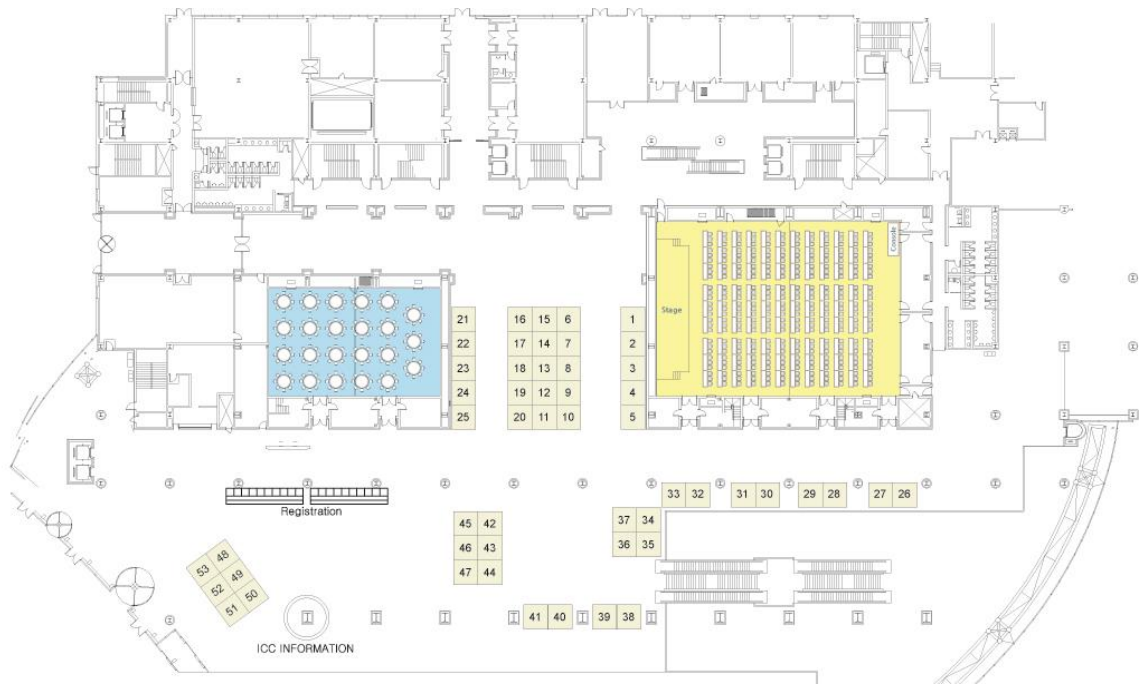

[Contact List]

The 1st International Electric Vehicle Expo Secretariat

PRIME COMMUNICATION (Contact: Mr. dongyoung, Kim): Exhibition

803 Jejuventuremaru, 1176-67 Idoi-dong, Jejusi, Jeju, Korea #690-827

Tel : +82-64-744-1140

Fax : +82-64-744-2240

E-mail : ssamq2001@naver.com

Website : www.ieve2014.org

ICC JEJU

2700 Jungmun, Seowipo Jeju Special Self-Governing Province, Korea

Tel: +82-64-735-1000

Fax: +82-64-738-8988

Website: www.iccjeju.co.kr

Terms and Regulations for Exhibition

1. TERMS OF REFERENCES

- (a) The term 'Exhibitor' refers to all employees, servants and agents of any company, partnership or individual who have applied for exhibition at the IEVE.
- (b) The term 'Exhibition' refers to the Exhibition of the IEVE.
- (c) The term 'Organizer' refers to the Organizing Committee of the IEVE.

2. APPLICATION FOR PARTICIPATION

- (a) All applications for participation shall be made on the enclosed contract form which shall be submitted to the Organizer or its representatives.
- (b) The contract shall be established when the Exhibitor submits the contract form. The Organizer holds the right to refuse application when there is no booth space available and when the Organizer deems the exhibit items not appropriate for the Exhibition.

3. ALLOCATION OF EXHIBIT SPACE

- (a) The Organizer shall allocate the space in the order of exhibition application, space requested, and the nature of the exhibits or in the manner the Organizer deems fit.
- (b) The Organizer shall reserve the right to change the space allocation of the Exhibitor at any time prior to the build-up of the Exhibition, if any exceptional circumstances demand. Such changes shall be at the discretion of the Organizer and the Exhibitor shall have no claim for compensation as a result of the changes.

4. USE OF EXHIBIT SPACE

- (a) Exhibitors are bound to exhibit the products listed in the contract form by the Exhibitor, and to manage the exhibits with competent personnel during the Exhibition.
- (b) The Organizer holds the right to refuse entrance of certain persons to the Exhibition.
- (c) Exhibitors are not allowed to sub-let the space allocated to them to other parties either wholly or in part without written consent of the Organizer.
- (d) Modifications including decoration such as painting the floor, ceiling and pillars will not be permitted, and consequent damage to the Exhibition shall be compensated for by the exhibitor.

5. Payment condition

The exhibitors shall pay the 50% deposit for the entry fee when submitting the application for participation, and the remaining 50% shall be paid by **Feb. 15, 2014**.

6. Cancellation

In an event when an exhibitor surrenders or refuses to use the contracted exhibition area without approval, the host can cancel the contract concluded with the exhibitor. In such case, the host shall not refund the paid entry fee to the exhibitor.

In case an applicant cancels the participation in the exhibition within the due date of application on **Jan. 31, 2014**, 50% of the total participation fee shall be refunded to the applicant after the approval of the host organization. But, if an applicant files such a cancellation of participation beyond the due date of application, the participation fee cannot be refunded to the applicant.

7. Cancellation or change of the exhibition

In an event when the host cancels the holding of the exhibition, the paid entry fee shall be refunded to the exhibitor. However, if the exhibition was cancelled owing to a special circumstance not caused by the host or in an event that the date/place of the event was changed or the scale of the event was reduced, the entry fee shall not be refunded. In such case, the exhibitors cannot ask for any compensation from the host.

8. Exhibition and display of the exhibits

The exhibitor shall complete the delivery and display of the necessary equipments and exhibits in the assigned exhibition area within the designated period.

9. DISMANTLING OF EXHIBITS

Exhibitors shall remove all exhibits from the Exhibition Hall within the period stipulated by the Organizer and shall indemnify the Organizer against any loss by reason of delay or damage to the Exhibition Hall.

10. SECURITY

- (a) The Organizer shall take all reasonable security precautions in the interests of Exhibitors and Visitors.
- (b) The Exhibitor is fully responsible for any loss or theft of or damage to exhibits at the Exhibition Hall during the build-up, exhibition and dismantling periods.
- (c) The Exhibitor is fully responsible for compensation of the intentional or unintentional damages caused by the Exhibitor, and the Exhibitor shall be responsible for the insurance of exhibiting items.

11. FIRE REGULATIONS

- (a) Materials used in stand and display construction must be properly fire-proofed in accordance with regulations of Korea Fire Department.
- (b) The Organizer has right, should circumstances necessitate, making changes in the Exhibitor's booth in the interest of fire prevention.

12. SUPPLEMENTARY CLAUSES

- (a) Whenever necessary, the Organizer shall have the right to issue supplementary regulation in addition to those in the Terms and Regulations for Exhibition.
- (b) Any additional written regulatory instruction shall form part of the Terms and Regulations for Exhibition and they shall be followed by the Exhibitor.

13. ARBITRATION OF DISPUTES

Any dispute, difference or question which may arise at any time hereafter between the Organizer and the Exhibitor touching on the true construction of these Terms and Regulations for Exhibition or the rights and liabilities of the parties hereto shall be settled by arbitration in accordance with the Commercial Arbitration Rules of the Korean commercial Arbitration Board in Jeju. The award of the above arbitration shall be final binding upon both parties.